

Dudley

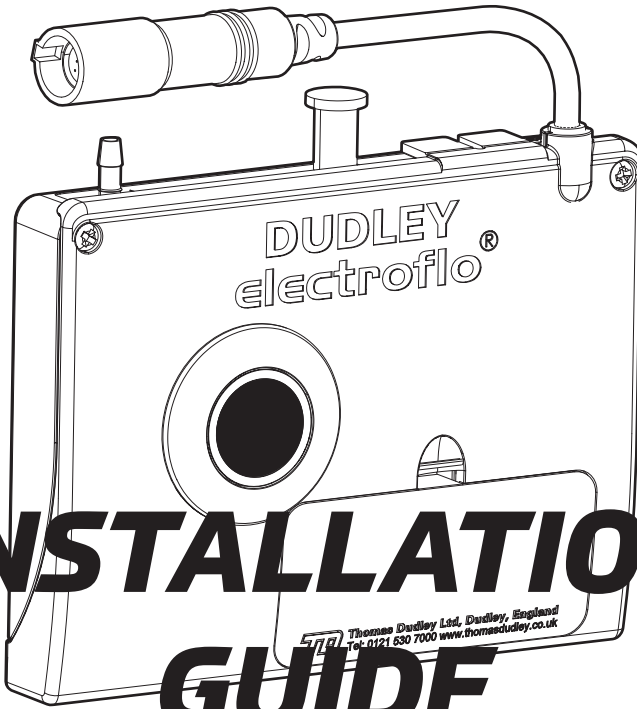

ELECTROFLO®

INFRARED TOUCH FREE FLUSH SENSOR



INSTALLATION GUIDE

IMPORTANT NOTES

Ensure the sensor is positioned to avoid obstruction at all times.

During installation do not expose the electronics to fluids, dust, dirt or damp.

Installation of the mains adaptor must be carried out and checked by a qualified electrician.

No after-market mains power packs to be used with this product. Use OEM supplied power pack only.

Do not kink or trim supplied air tubes.

1 PACK CONTENTS

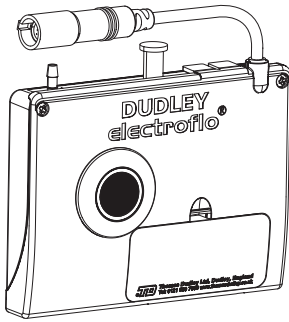

CONTROL UNIT



FIXING NUT

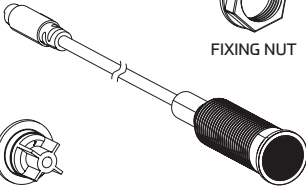

INFRA-RED
SENSOR WITH
CABLE



MOUNTING
ADAPTOR

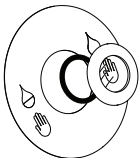

DOMESTIC
SURROUNDS

[OR]



COMMERCIAL
SURROUNDS

2



Ensure the sensor is positioned to avoid obstruction at all times. It is recommended that the sensor is positioned to the left or right of the WC pan at a suitable height for the intended user.

SENSOR MOUNTED UNIT

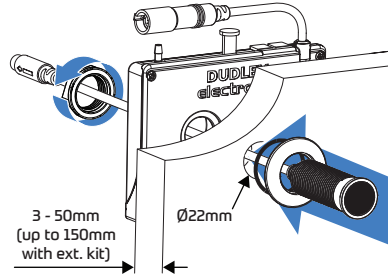

INDEPENDENTLY MOUNTED

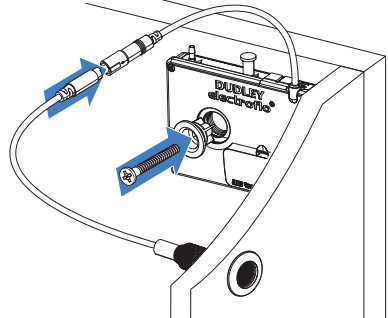

3

DOMESTIC SURROUNDS ONLY

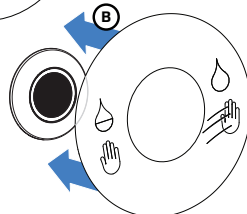
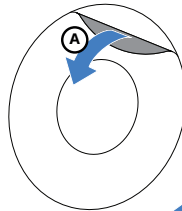

4 CONNECTIONS

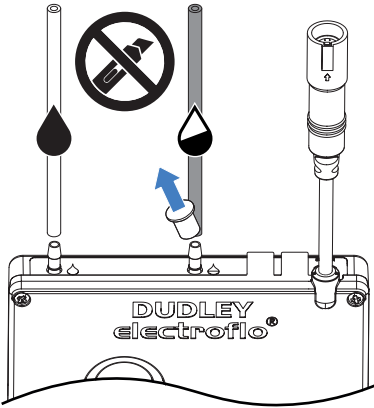

5a BATTERY POWER-UP

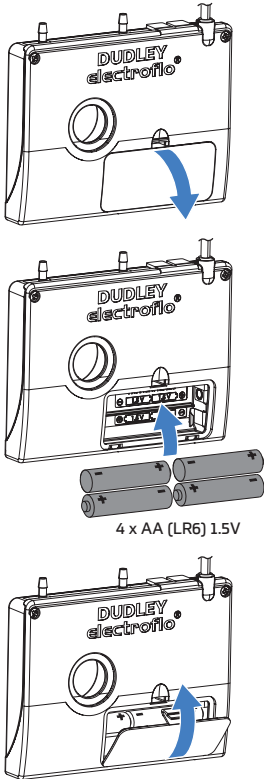

5b MAINS POWER-UP

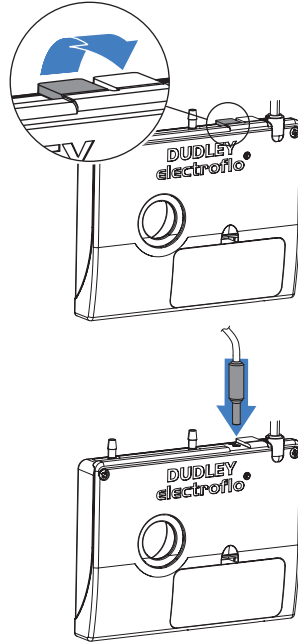

6 OPERATION AND INDICATION

FULL FLUSH

REDUCED FLUSH

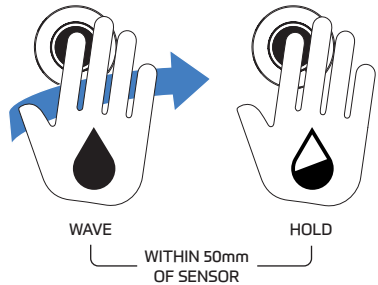

INDICATION	LED COLOUR	STATUS
SOLID FLASH	BLUE	FULL FLUSH
SOLID FLASH	GREEN	REDUCED FLUSH
LIT FOR 15 SEC. AFTER FLUSH	RED	FILL DELAY
RAPID FLASH	RED	BATTERY LOW
SLOW FLASH	RED	SENSOR OBSTRUCTION

7 FLUSH CONVERSION

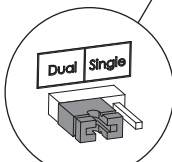
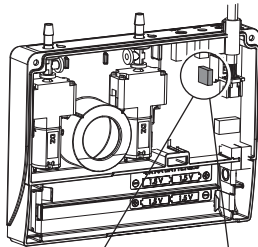
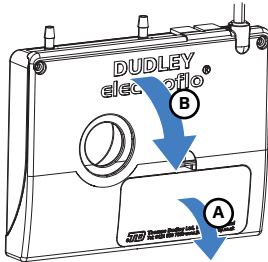
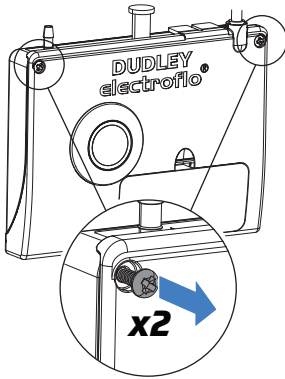

DUAL FLUSH

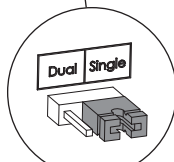

SINGLE FLUSH

© 2025 TD_SISCT322758_11267 Iss Q

Thomas Dudley
 295 Birmingham New Road
 Dudley, West Midlands
 United Kingdom
 DY1 45J

t +44 (0)121 557 5411
 f +44 (0)121 557 5345
 e info@thomasdudley.co.uk
 w www.thomasdudley.co.uk/plumbing

8 PUMP BOOST

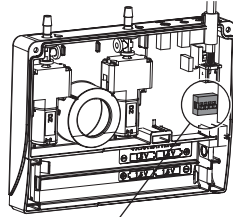

FULL FLUSH		REDUCED FLUSH		SWITCH SETTING	PUMP RUN TIME (SEC)
ON	OFF	OFF	OFF	OFF OFF	1.8
ON	OFF	ON	OFF	OFF ON	2.1
ON	OFF	ON	ON	ON OFF	2.4
ON	ON	ON	ON	ON ON	2.7

9 Final Installation Checklist

- ~ Check flush valve instructions for correct valve connection procedure.
- ~ Ensure air tubes are connected securely and routing is free from kinks and acute bends.
- ~ Check full and reduced flush operation.
- ~ Visit thomasdudley.co.uk/plumbing for service & maintenance information.

T H O M A S
 D U D L E Y

