



#### Applications

Cistern/tank inlet valve. For use in both domestic and commercial environments.

#### Features

- ~ Brass float operated
- ~ Ballvalve supplied with removable seats and brass backnuts
- ~ BS1212 Part 1



#### Dimensional Data

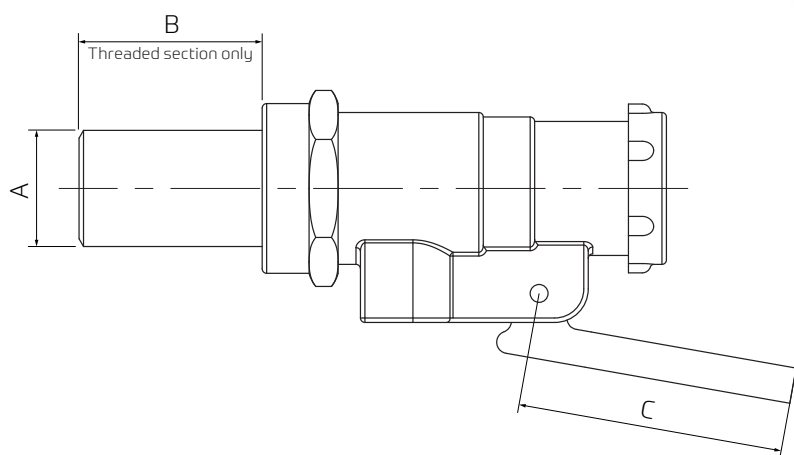

#### Technical Data

	(A) Inlet	(B) Tail Length	(C) Lever Length	Seat	Piston	Float Thread	Rec. Float Size	Back Nuts	Max P.	WRAS Approved
<b>High Pressure</b>										
366901	3/4" BSP	1 1/2"	13"	1/4" Acetal	Acetal	5/16" BSW	6"	Brass	20 bar	-
366902	3/4" BSP	3"	13"	1/4" Acetal	Acetal	5/16" BSW	6"	Brass	20 bar	-
366836	1" BSP	1 1/2"	16"	3/8" Acetal	Brass	7/16" BSW	8"	Brass	20 bar	-
366854	1 1/4" BSP	1 3/4"	22"	3/4" Brass	Brass	9/16" BSW	10"	Brass	20 bar	-
366856	1 1/2" BSP	1 3/4"	22"	3/4" Brass	Brass	9/16" BSW	10"	Brass	20 bar	-
366858	2" BSP	2"	29"	1" Brass	Brass	5/8" BSW	12"	Brass	20 bar	-
<b>Low Pressure</b>										
366914	3/4" BSP	1 1/2"	13"	1/2" Acetal	Acetal	5/16" BSW	6"	Brass	20 bar	-
366915	3/4" BSP	3"	13"	1/2" Acetal	Acetal	5/16" BSW	6"	Brass	20 bar	-
366855	1 1/4" BSP	1 3/4"	22"	5/16" Brass	Brass	9/16" BSW	10"	Brass	20 bar	-
366859	2" BSP	2"	29"	1.1/4" Brass	Brass	5/8" BSW	12"	Brass	20 bar	-