



Applications

Free-standing wall-hung WC pan support frame designed for use where no solid rear wall fixing is available.

Can be used against flat walls and in corners in domestic or commercial environments.

Features

- ~ Sturdy floor fixing brackets remove the need for rear wall fixing
- ~ Legs adjust to offer WC pan height fixing flexibility
- ~ Strong steel square hollow construction
- ~ Blue powder coated finish & zinc plated wall & floor brackets
- ~ Flushbend and WC pan connector clamps
- ~ 5L & 4L mono flush is achievable

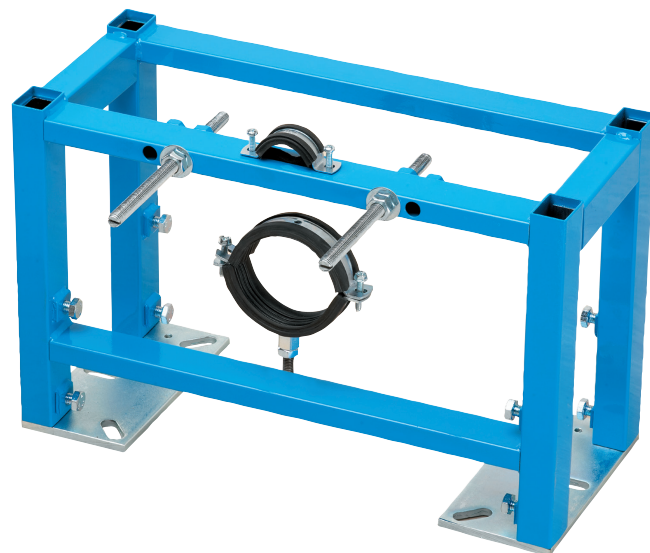

Dimensional Data

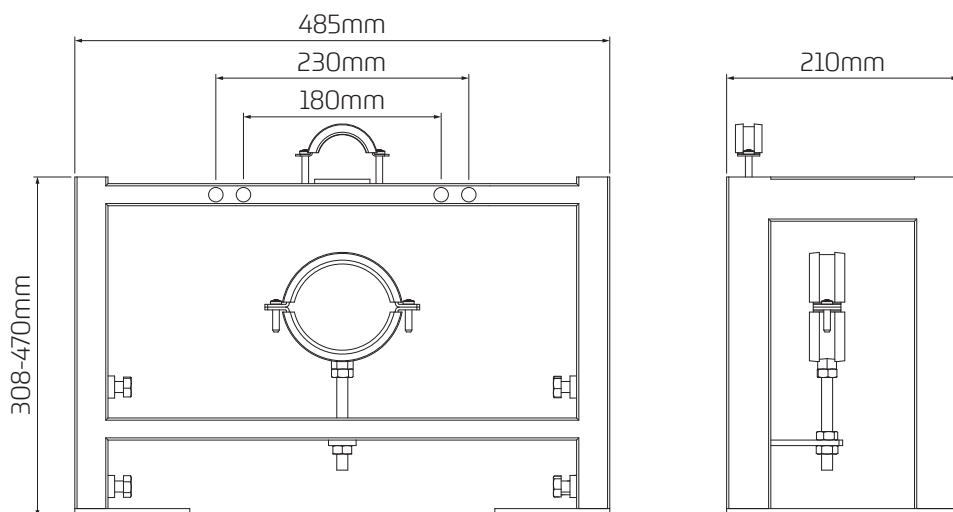

Technical Data

Fixing orientation	Floor fixed
Code	316233