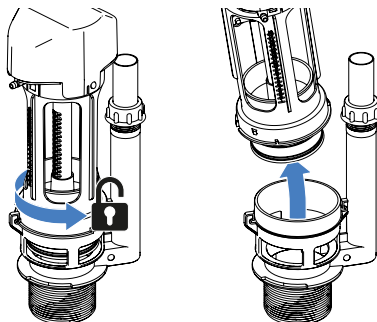
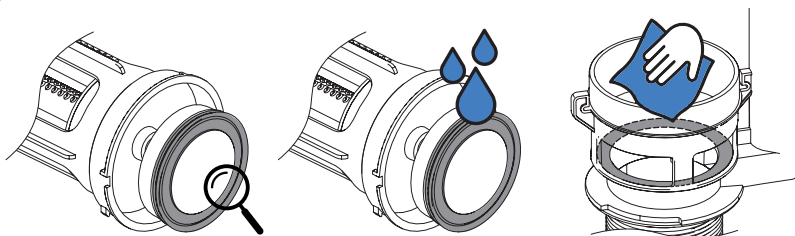

**IMPORTANT NOTES**

No sealing compound, paste, flux or solvent to be used in contact with plastic or rubber surfaces to avoid damage. Rubber washers will provide adequate seal. PTFE tape may be used on threads. No chemical block/additive to be used in the cistern.

1**2**

Inspect seal for damage
and replace if necessary

Carefully clean seal
under running water

Clean sealing face of valve body
with water and a soft cloth

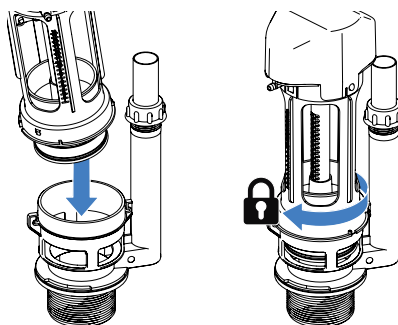
3

© 2025 TD_SISLF377548_15887 Iss B