

Dudley

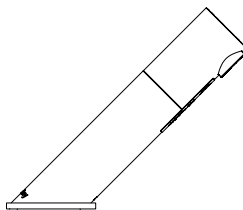

ELECTROFLO
TAPS

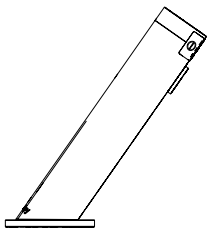
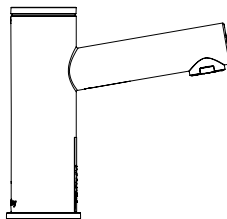
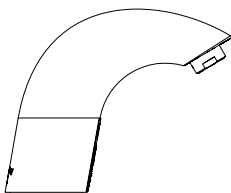
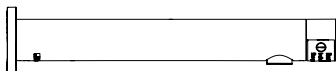

INSTALLATION GUIDE



Scan this QR code, provide
some feedback and be
entered in our monthly prize
draw.

T H O M A S
D U D L E Y



IMPORTANT NOTES

DO NOT Install the sensor facing a mirror or any other electronic system operated by an infra-red sensor.

Leave sufficient space for all the components under the work top, such as the solenoid, mains transformer or battery pack.

Prior to installation, flush water supply lines thoroughly before installing the tap.

DO NOT allow dirt, teflon tape or metal particles to enter the tap.

Prior to installation, shut off water supply lines.

DO NOT use steel wool or cleaning agents containing alcohol, acids, abrasives, etc as this will cause damage to the surface. Use only soap and water and then wipe dry with a clean cloth or towel. When cleaning bathroom tile, the taps should be protected from any splattering of harsh cleansers.

DO NOT place objects on top of sensor.

TECHNICAL DATA

Power Supply	9V lithium battery (not included) or 9V transformer
Recommended Water Pressure	0.5 - 8 bar (7-116 PSI)
Security Time	90 seconds
Water Temperature	Max: 70°C
Sensor Range	
-Arc	80-300mm Preset: 180mm
-Avanti	50-160mm Self Adjusts
-Contemporary	35-300mm Preset: 200mm
-Horizon	35-300mm Self Adjusts
-Linear	100-300mm Self Adjusts

1a

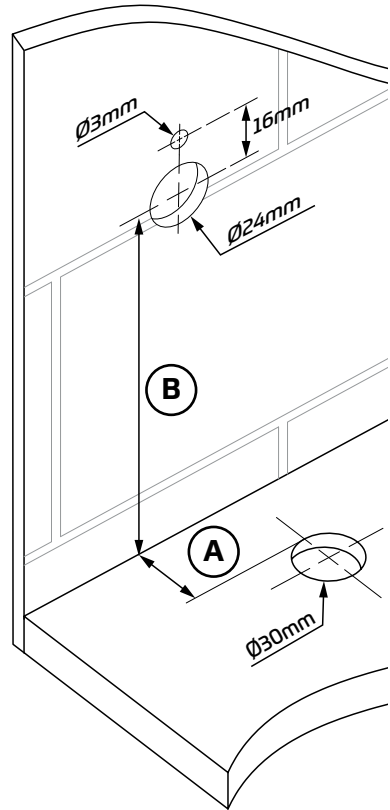

Tap	Min Dim A (mm)	Min Dim B (mm)	Maximum Surface Thickness (mm)
Arc	20	-	25
Avanti	10	-	40
Contemporary	10	-	40
Horizon	-	318	50
Linear	20	-	40

2a AVANTI, CONTEMPORARY

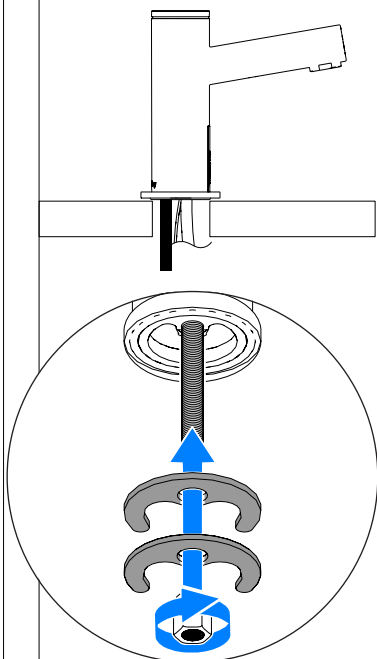

2b ARC, LINEAR

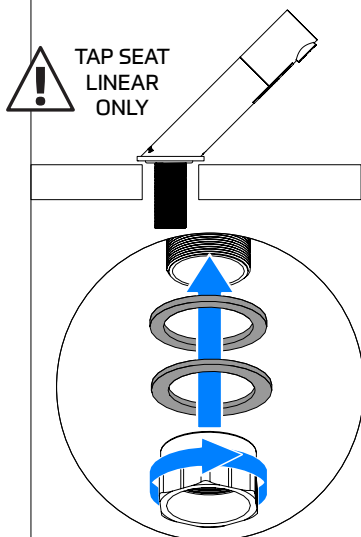

2c HORIZON

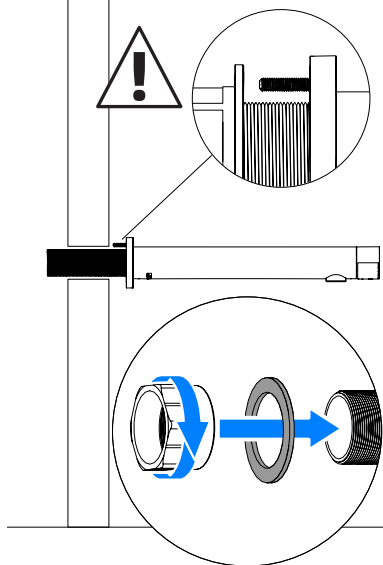

3 ADJUSTING THE AERATOR

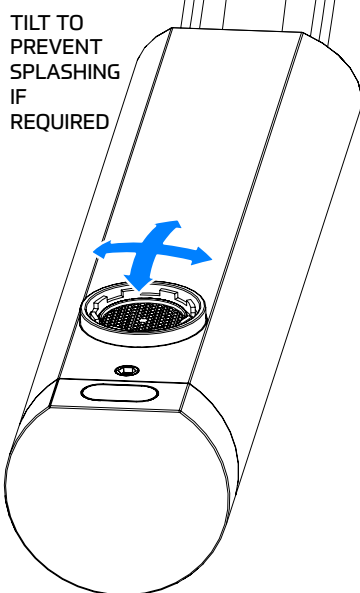

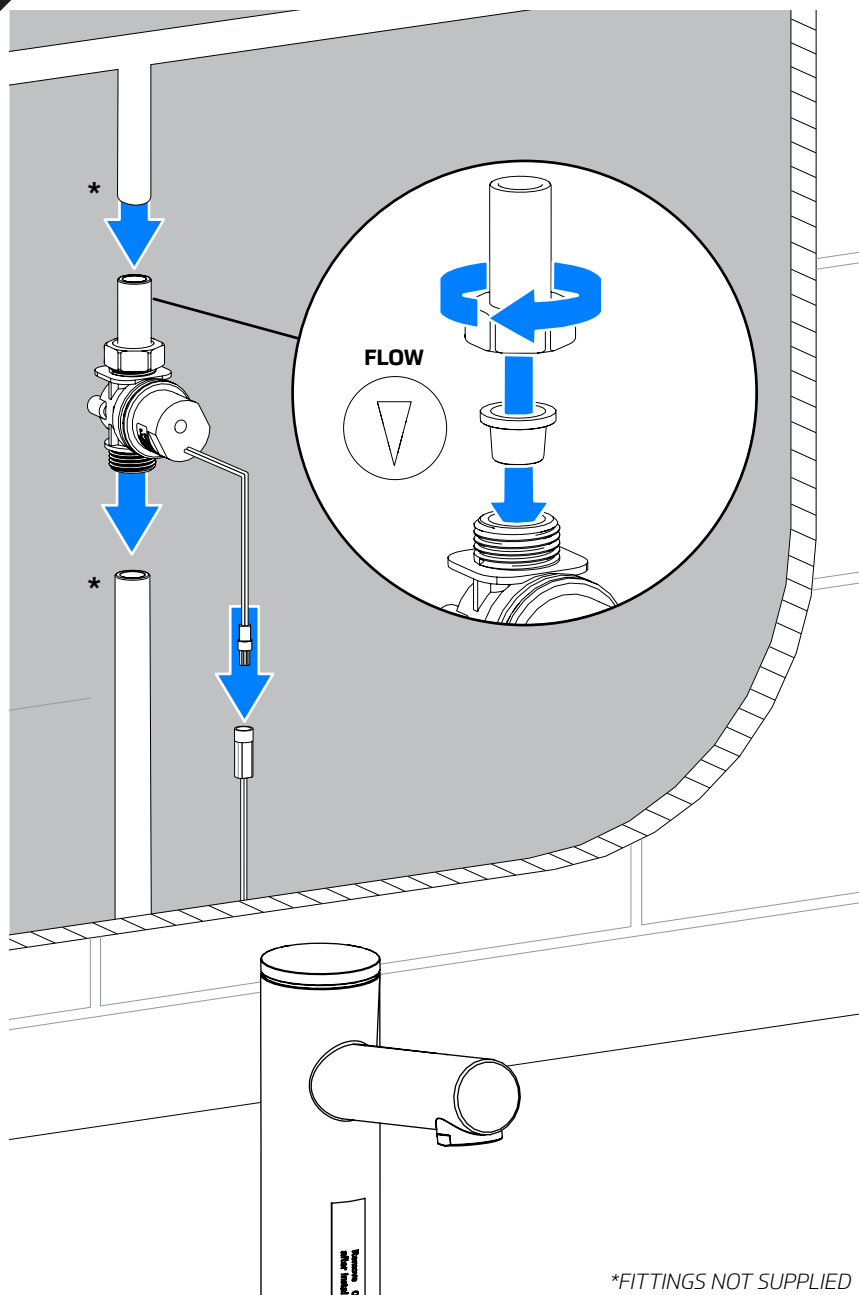

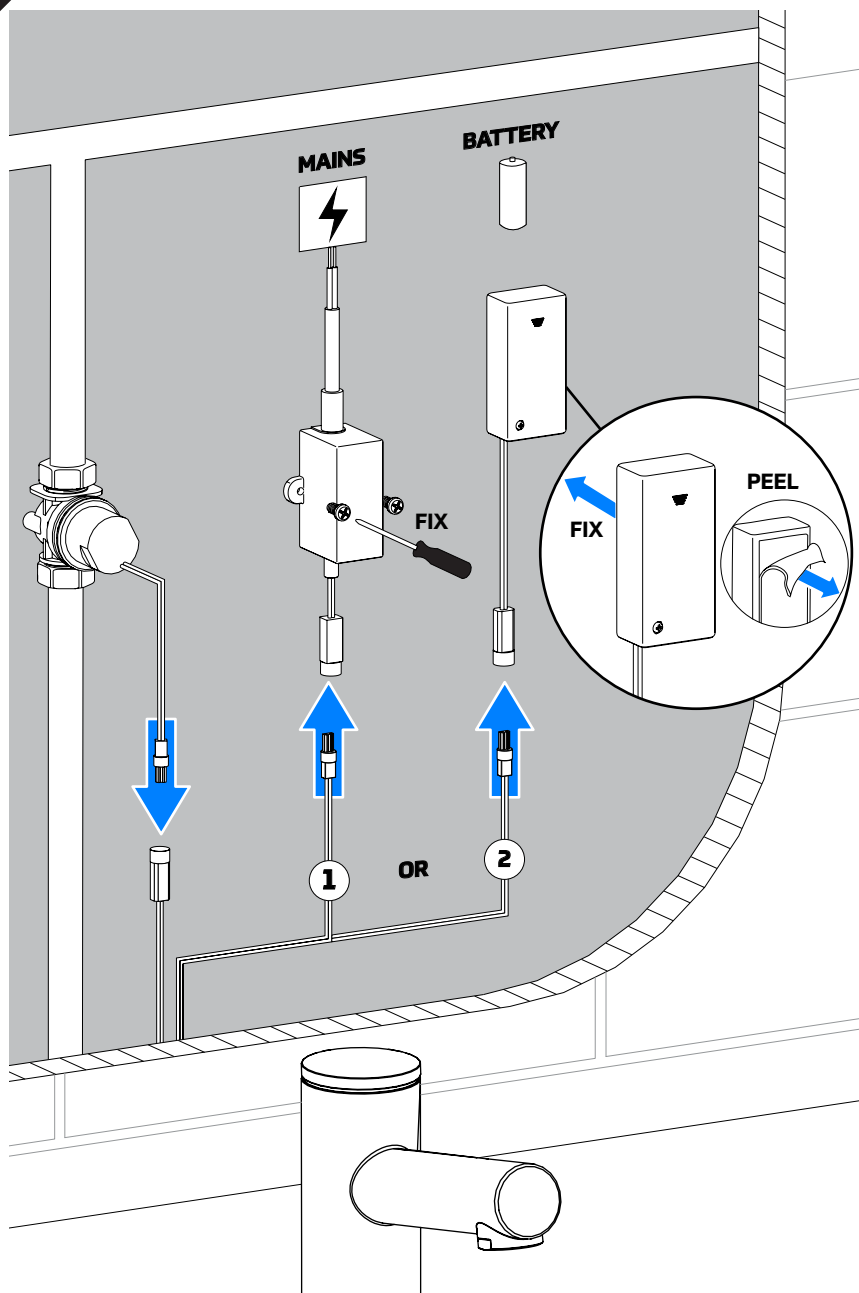

Detection **RANGE**. If necessary press the button and use the +/- keys to adjust range between 300-800mm.

DELAY IN TIME is the time between sensor detection and water flow. Press this button until sensor LED blinks and use the +/- buttons to adjust.

DELAY OUT TIME is the flow time after sensor detection. Press this button until sensor LED blinks and use the +/- buttons to adjust flow time.

DECREASE

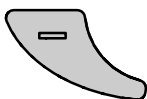

INCREASE

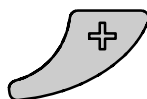

Automatically **ADJUSTS** sensor range. The solenoid valve will open for 1 second to indicate range is set.



If **FACTORY RESET** is required press and hold this button and press + button once.



By default, if the sensor is covered for more than 90 seconds the waterflow will shut off automatically. If this time needs to be changed press **SECURITY TIME** and use the +/- buttons.



Flush is pre-set to cycle every 24hrs for **HYGIENE FLUSH**. Press the button and use the +/- buttons to turn on/off.



Flush is pre-set to cycle every 24 hrs for **HYGIENE FLUSH**. Press this button and use the +/- buttons to turn on/off.

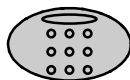

Turns **Sensor Off** for 1 minute to allow for cleaning. To cancel press the button again.



Not applicable with Electrifo Taps.

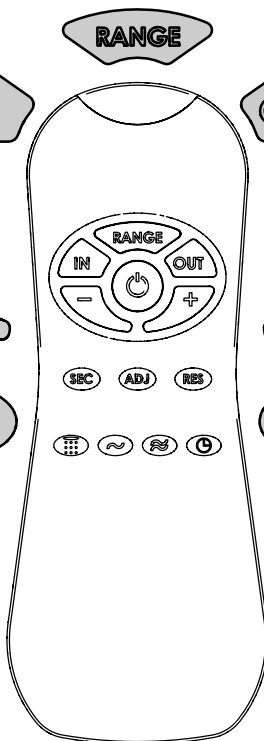

7 CHANGING BATTERY

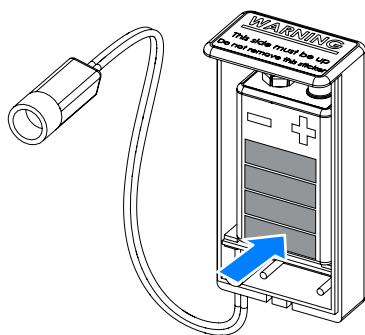
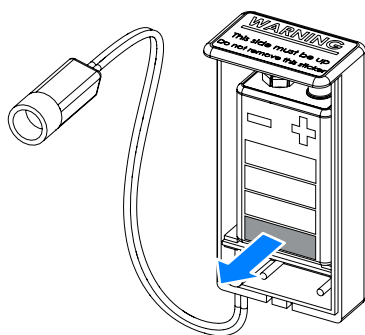
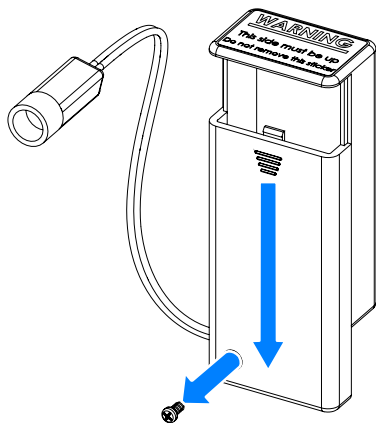

8 CLEANING FILTER

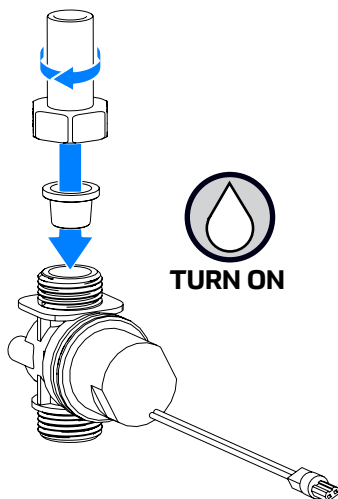
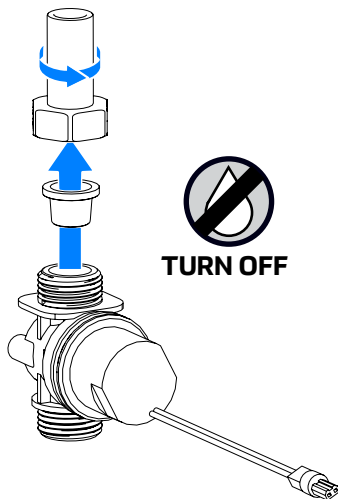

Trouble Shooting

Problem	Cause	Solution
No water coming out of the tap	1) Dirty solenoid valve	Unscrew solenoid valve, remove plunger and spring and clean with water. When replacing the spring, make sure it is in the vertical position.
	2) Aerator blocked	Check the aerator for any blockages.
	3) (Battery powered version only) Low battery	Replace battery.
	4) Connectors not fully inserted	The connectors should be inserted fully until white o-ring is not visible. Remove the o-ring if necessary. Keep dry.
	5) Reflection issue form other objects	Make sure no objects are obscuring the sensor. Make sure the sensor is not facing a mirror.
	6) Incorrect water pressure	Check the water supply pressure. It must be between 0.5 - 8 bar (7 - 116 PSI). For water pressures above 8 bar, use a pressure reducing valve.
Water does not stop coming out of the tap	1) Connectors not fully inserted	The connectors should be inserted fully until white o-ring is not visible. Remove the o-ring if necessary. Keep dry.
	2) Spring is not in solenoid correctly	Unscrew solenoid valve, remove plunger and spring and clean with water. When replacing the spring, make sure it is in the vertical position.
	3) Dirty solenoid valve	Unscrew solenoid valve, remove plunger and spring and clean with water. When replacing the spring, make sure it is in the vertical position.
	4) Reflection issue from other objects	Make sure no objects are obscuring the sensor. Make sure the sensor is not facing a mirror.

© 2025 TD_R328138_12579 Iss C

Thomas Dudley
 295 Birmingham New Road
 Dudley, West Midlands
 United Kingdom
 DY1 4SJ

t +44 (0)121 557 5411
f +44 (0)121 557 5345
e info@thomasdudley.co.uk
w www.thomasdudley.co.uk/plumbing

T H O M A S
D U D L E Y

